

BUILDING ACOUSTICS & LIGHTING LABORATORIES, INC.

1618 HEADLAND DR.
 FENTON, MO 63026
 (636) - 343-6006
 (636) - 343-6051 FAX

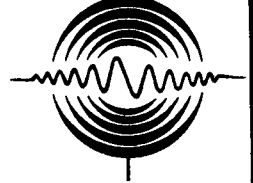

BALLABS CERTIFIED TEST REPORT NO.: 13322.0 DATE 11/02/06
 PREPARED FOR: MARK ARCHHITECTURAL LIGHTING - EDISON, NJ
 DESCRIPTION: 2/54W T5HO LAMP 2x4'RECESSED DIRECT LUMINAIRE w/WHITE REFL
 CLEAR INTERIOR/WHITE EXTERIOR PVC MEMBRANE PANEL DOOR
 ADVANCE BALLAST #ICN-2S54 WATTS=119 REFL=84%
 CATALOG NBR: VEIL-24-2T5HO
 LAMP TYPE : FP54T5HO/835 RATED LUMENS 5000. NBR. LAMPS:- 2

CANDLEPOWER DISTRIBUTION

VERT ANG	HORIZONTAL ANGLE					ZONAL LUMENS
	0	22.5	45	67.5	90	
0	1828.	1828.	1828.	1828.	1828.	
5	1807.	1806.	1806.	1806.	1806.	172.4
10	1816.	1816.	1815.	1815.	1813.	
15	1770.	1770.	1770.	1768.	1768.	501.5
20	1752.	1750.	1749.	1748.	1748.	
25	1636.	1635.	1634.	1633.	1633.	756.4
30	1536.	1534.	1534.	1533.	1531.	
35	1426.	1425.	1424.	1421.	1421.	894.2
40	1318.	1317.	1316.	1313.	1315.	
45	1261.	1260.	1258.	1257.	1257.	974.6
50	1080.	1077.	1077.	1075.	1076.	
55	940.	940.	938.	936.	938.	841.8
60	771.	770.	769.	766.	766.	
65	640.	639.	638.	637.	637.	633.4
70	487.	487.	487.	487.	487.	
75	334.	334.	334.	335.	335.	353.7
80	201.	201.	202.	205.	205.	
85	87.	88.	88.	88.	89.	96.0
90	0.	0.	0.	0.	0.	

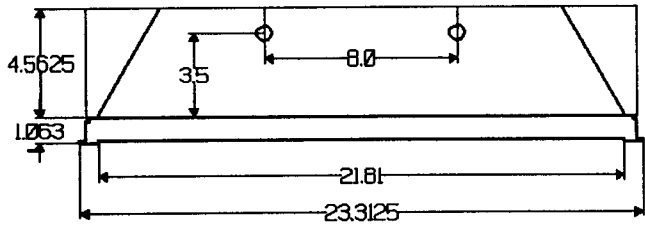
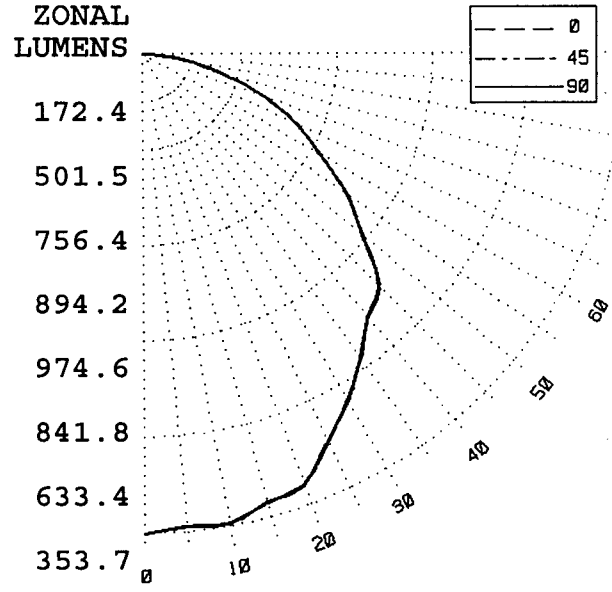

Handwritten signature

LUMEN SUMMARY

ZONE	LUMENS	%LAMP	%FIXT	ZONE	LUMENS	%LAMP	%FIXT
0- 30	1430.	14.3	27.4	90-120	0.	.0	.0
0- 40	2324.	23.2	44.5	90-130	0.	.0	.0
0- 60	4141.	41.4	79.3	90-150	0.	.0	.0
0- 90	5224.	52.2	100.0	90-180	0.	.0	.0
TOTAL LUMINAIRE = 0-180					5224.	52.2	100.0

IES SPACING CRITERIA: END= 1.2 DIAGONAL = 1.2 CROSS= 1.2

SIGNIFICANCE OF THE TEST IS LIMITED TO THE DEGREE THAT THE TESTED SAMPLE IS REPRESENTATIVE. OTHER FACTORS AFFECT FIELD PERFORMANCE.

BALLABS CERTIFIED TEST REPORT NO.: 13322.0 DATE 11/02/06
 PREPARED FOR: MARK ARCHHITECTURAL LIGHTING - EDISON, NJ
 DESCRIPTION: 2/54W T5HO LAMP 2x4'RECESSED DIRECT LUMINAIRE w/WHITE REFL
 CLEAR INTERIOR/WHITE EXTERIOR PVC MEMBRANE PANEL DOOR
 ADVANCE BALLAST #ICN-2S54 WATTS=119 REFL=84%
 CATALOG NBR: VEIL-24-2T5HO
 LAMP TYPE : FP54T5HO/835 RATED LUMENS 5000. NBR. LAMPS:- 2

LUMINANCES-CD/SQ-M
 HORIZONTAL ANGLE

VERT ANGLE	0	45	90
45	2686.	2680.	2678.
55	2469.	2463.	2463.
65	2281.	2274.	2270.
75	1944.	1944.	1950.
85	1504.	1521.	1538.

MAXIMUM BRIGHTNESSES NOT MEASURED

ZONAL CAVITY COEFFICIENTS OF UTILIZATION

EFFECTIVE FLOOR CAVITY REFLECTANCE=.20

CEILING	.80		.70		.50		.30		.10		.00							
WALL	.70	.50	.30	.10	.70	.50	.30	.10	.50	.30	.10	.50	.30	.10	.50	.30	.10	.00
RCR																		
0	.62	.62	.62	.62	.61	.61	.61	.61	.58	.58	.58	.56	.56	.56	.53	.53	.53	.52
1	.57	.55	.53	.51	.56	.54	.52	.50	.52	.50	.49	.50	.48	.47	.48	.47	.46	.45
2	.52	.48	.45	.42	.51	.47	.44	.42	.46	.43	.41	.44	.42	.40	.42	.40	.39	.38
3	.48	.43	.39	.36	.47	.42	.38	.35	.41	.37	.35	.39	.36	.34	.38	.35	.33	.32
4	.44	.38	.34	.30	.43	.37	.33	.30	.36	.32	.30	.35	.32	.29	.34	.31	.29	.28
5	.40	.34	.29	.26	.39	.33	.29	.25	.32	.28	.25	.31	.28	.25	.30	.27	.25	.24
6	.37	.30	.25	.22	.36	.30	.25	.22	.29	.25	.22	.28	.24	.22	.27	.24	.21	.20
7	.34	.27	.22	.19	.33	.27	.22	.19	.26	.22	.19	.25	.21	.19	.24	.21	.19	.18
8	.31	.24	.20	.17	.30	.24	.20	.17	.23	.19	.16	.22	.19	.16	.22	.19	.16	.15
9	.29	.22	.17	.14	.28	.21	.17	.14	.21	.17	.14	.20	.17	.14	.20	.16	.14	.13
10	.27	.20	.15	.13	.26	.19	.15	.13	.19	.15	.13	.18	.15	.12	.18	.15	.12	.11

TESTED IN ACCORDANCE WITH CURRENT IES PROCEDURES